

Mindesttiefen Elemente

Beplankung 1 x 18 mm



Vorwand + Freistehend

Riedgrabenstrasse 12, 8153 Rümlang
Telefon 043/211 20 20
E-Mail info@vorfa-plast.ch
Web www.vorfa-plast.ch

www.vorfa-plast.ch/dokumente

2022-1 / dr

Mindesttiefen 1 x 18mm

1 Vorwände

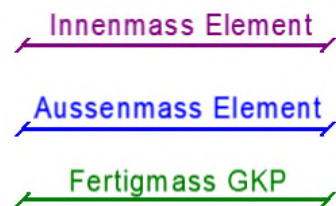
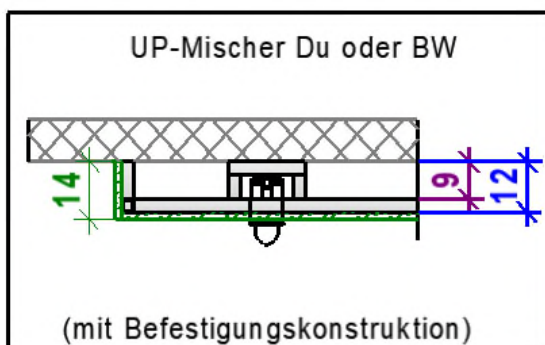
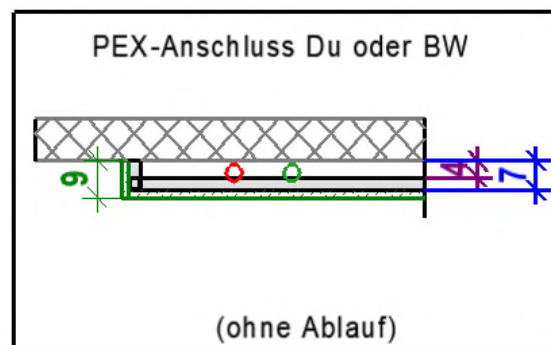
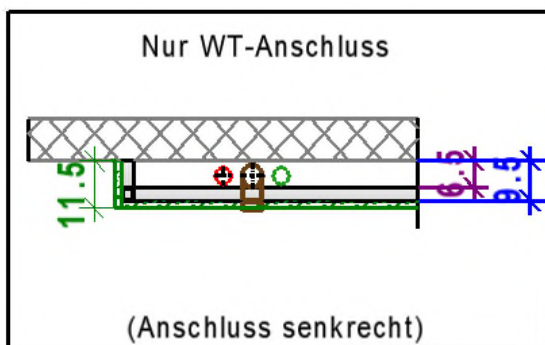
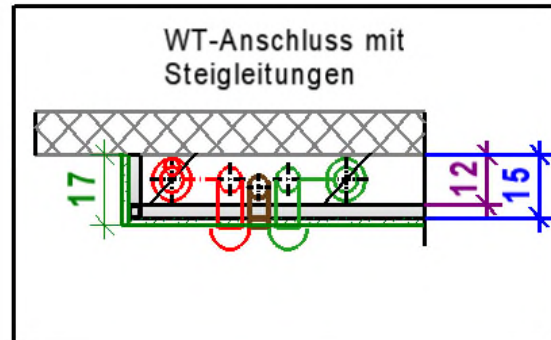
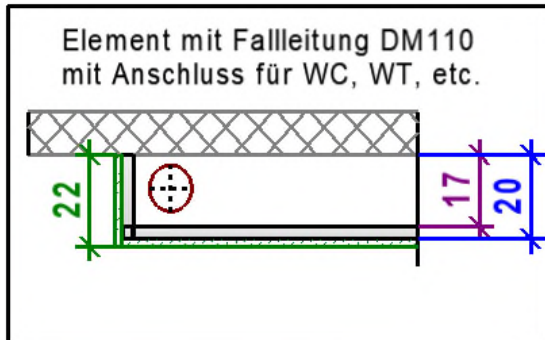

Mindesttiefen 1 x 18mm

2 Trennwände

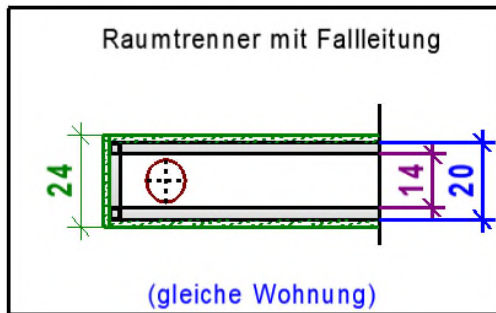

Schmutzwasser:
Hosen-T 110/90 bei WC

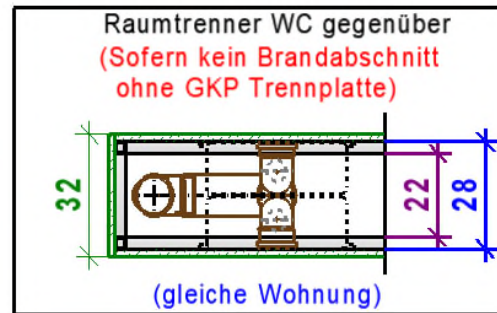

Schmutzwasser:
Hosen-T 110/110 bei WC

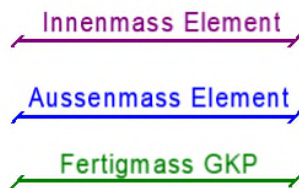

Horizontaler und vertikaler
Brandschutztest

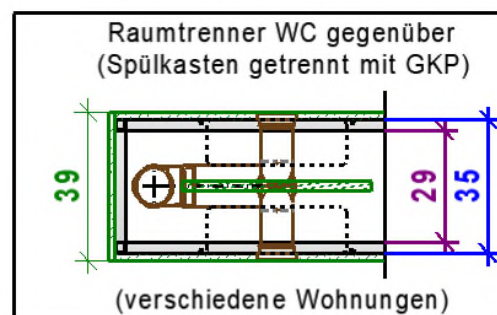

Die thermische Trennung der
Spülkasten erfolgt mit einer
Gipsplatte.

